

LEGEND

SYMBOL	DESCRIPTION
	STOBIE POLE
	LIGHT POLE
	TRAFFIC SIGNAL POLE
	POLE ID
	COMBINATION LIGHTING / TRAFFIC SIGNAL POLE
	COMBINATION LIGHTING / TRAFFIC SIGNAL POLE WITH MAST ARM (3.5m OUTREACH)
	PEDESTRIAN PUSH BUTTON - AUDIO TACTILE
	TWO ASPECT PEDESTRIAN LANTERN
	THREE ASPECT LANTERN WITH OPEN VISOR
	SIGNAL CONTROLLER (ALDRIDGE I-CUPS ELV 42V WITH UPS CONNECTED TO SCATS)
	PROPOSED NEW COUNCIL METERED SWITCHBOARD
	INDUCTIVE LOOP DETECTOR
	SERVICE POINT



NOTES:

- TRAFFIC CONTROL DETAILS AND RETROREFLECTIVE RAISED PAVEMENT MARKERS INSTALLED IN ACCORDANCE WITH AUSTRALIAN STANDARD 'AS 1742 MANUAL OF TRAFFIC CONTROL DEVICES' AS MODIFIED BY THE DPTI 'CODE OF TECHNICAL REQUIREMENTS FOR THE LEGAL USE OF TRAFFIC CONTROL DEVICES', AND THE DPTI 'PAVEMENT MARKING MANUAL'.
- FOR SIGN INSTALLATION DETAILS REFER TO DPTI MASTER SPECIFICATION, PART R49 - INSTALLATION OF SIGNS.
- KERB RAMP ARE TYPE 1 AND 8 UNLESS OTHERWISE SHOWN. FOR PEDESTRIAN KERB RAMP INSTALLATION DETAILS REFER STANDARD DRAWING S-4020, SHEET 1 & STANDARD DRAWING S-4074, SHEETS 6 & 7.
- FOR CORNER ISLAND DETAILS REFER TO STANDARD DRAWING S-4076 SHEETS 1 & 2.
- ALL LANE DIMENSIONS QUOTED ARE TO THE CENTRE OF LINE MARKING OR TO THE FACE OF KERB.
- ALL VEHICLE LANTERNS ARE 200mm LED UNLESS OTHERWISE SHOWN.
- DESIGN VEHICLE TURNING PATHS USED WERE:
12.5m SU TRUCK.
LEFT AND RIGHT TURN INTO GAWLER STREET.

SIGN DETAILS

No.	CODE	DESCRIPTION
1	R2-2(L)A	ONEWAY (LEFT)
1	R2-5A	NO U TURN
1	R5-20(L)	BUS ZONE (LEFT)
1	R5-35(L)	NO STOPPING (LEFT)
2	R5-35(R)	NO STOPPING (RIGHT)
2	R6-4A(12)	GROSS LOAD LIMIT (12)
1	S24(L)	POLICE STATION (LEFT)

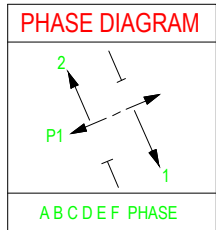
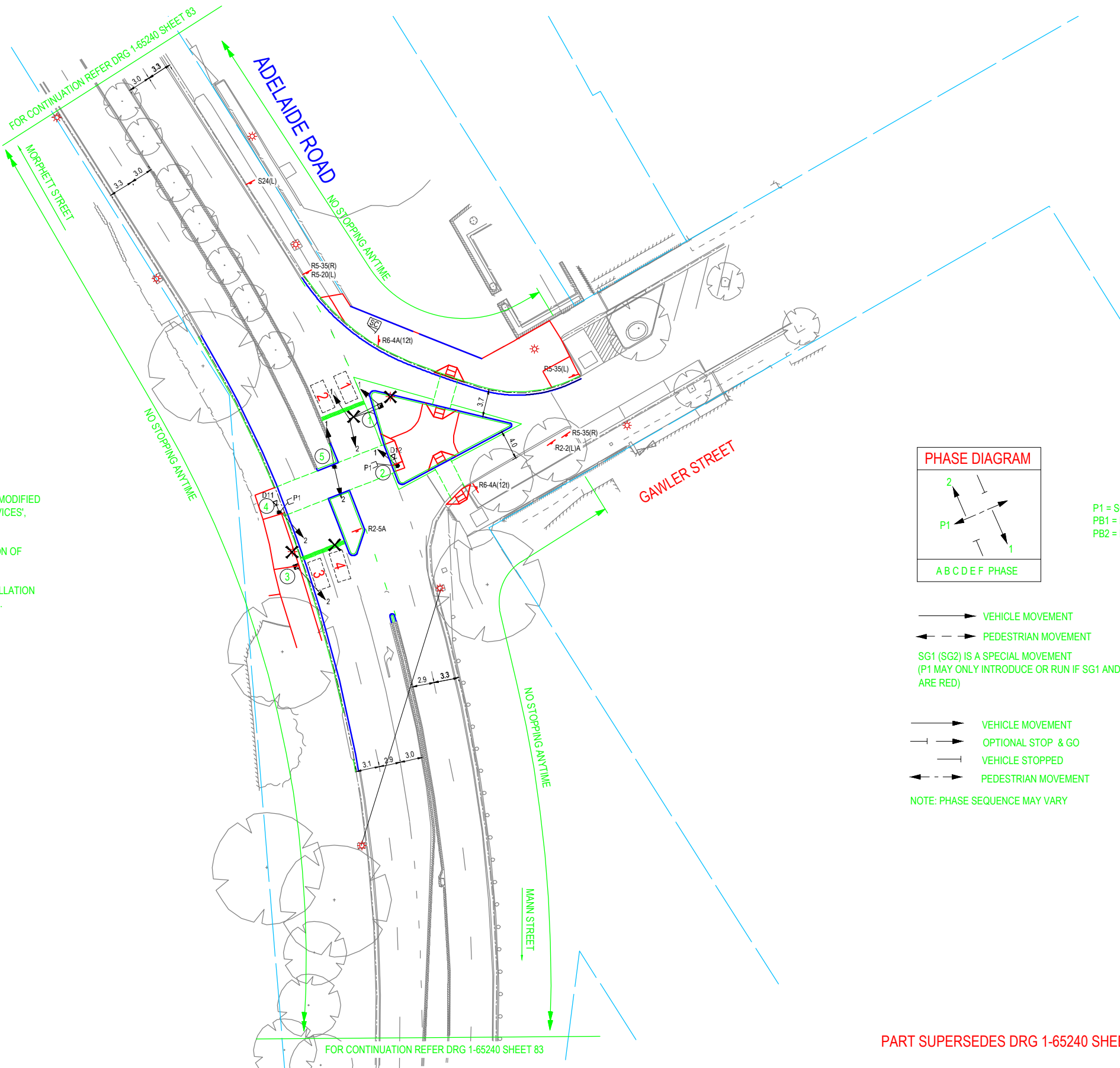

P1 = SG4
PB1 = DET 12
PB2 = DET 11

- VEHICLE MOVEMENT
 - PEDESTRIAN MOVEMENT
 - SG1 (SG2) IS A SPECIAL MOVEMENT (P1 MAY ONLY INTRODUCE OR RUN IF SG1 AND SG2 ARE RED)
 - VEHICLE MOVEMENT
 - OPTIONAL STOP & GO
 - VEHICLE STOPPED
 - PEDESTRIAN MOVEMENT
- NOTE: PHASE SEQUENCE MAY VARY

PART SUPERSEDES DRG 1-65240 SHEET 83

INDEX SHEET REFERENCE: 65240 SHEET 102



Government of South Australia
Department of Planning, Transport and Infrastructure

PROJECT No.: XXXXX	FILE No.: XX/XXXXX
DESIGN No.: XXXXXXXXX	SURVEY No.: XXXXXXXXX
PROJECT START ROAD RUNNING DISTANCE: XXXX; CH XXXX = XXX.XX km	
PROJECT END ROAD RUNNING DISTANCE: XXXX; CH XXXX = XXX.XX km	

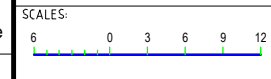

Road No:4646/NCRN
ADELAIDE ROAD
JUNCTION GAWLER STREET
MOUNT BARKER
TRAFFIC SIGNALS

SIGNAL No.:
PC382

No.	AMENDMENT DESCRIPTION	BY	CHECK	ACCEPTANCE	DATE
D	DET NUMBERS FOR PB's, EXTRA LANTERN TO POLE 2 AND NSAT ZONE ADDED	AGM	PCS		13.07.17
C	100% DESIGN RE-ISSUE FOR APPROVAL	AGM	PCS		04.07.17
B	100% DESIGN REVIEW	AGM	PCS		18.04.17
A	90% DESIGN REVIEW	AGM	PCS		30.01.17

UNCONTROLLED COPY WHEN PRINTED 100 MILLIMETRES ON ORIGINAL DRAWING ALL DIMENSIONS ARE IN METRES UNLESS SHOWN OTHERWISE

DESIGNED: TONKIN	DRAFTED: TONKIN	ACCEPTED FOR USE: X. XXXXXXXXXXXX	ACCEPTANCE FORM KNET No.: 11418319	DRAWING No.: 65240	SHEET No.: 107	AMEND No.: D
CHECKED: XXX	CHECKED: XXX	TITLE: XXXXXXXXXXXXXXXX DATE: DD/MM/YYYY	IN ACCORDANCE WITH DP013 SHEET LATITUDE -35.06789 SHEET LONGITUDE 138.8571			

CAD FILE NAME: 65240 SHEET 0107.DWG