



MOUNT BARKER
DISTRICT COUNCIL

Stephen Street Upgrade

Haley Irvine

Open Space and Urban Designer

30 January 2023



MOUNT BARKER
DISTRICT COUNCIL

Purpose

- To update Council Members on the status of the Stephen Street (South) Upgrade project
- Take any comments and input on the current design outcomes prior to tendering the project for construction in February 2023



Background

- Project included in the FY23 annual business plan and budget for design & construction
- Both streetscape & asset renewal components
- Both grant and Council funding committed to project



Location



Existing Situation

- Low value streetscape, vehicle dominated environment
- Poor pedestrian and cycle linkage between Gawler Street Precinct & Business/Retail Core
- Rutted & potholed road surface at end of asset life
- Stormwater network also in need of asset renewal



Benefits

- Key link as part of approved Town Centre Strategy 2012 and Gawler Street Strategy 2015 for vehicles, cyclists & pedestrians.
- Improved public realm & streetscape (inc. 13 new street trees)
- Pavement & stormwater asset renewal
- Enhanced public safety (lighting & increased usage)
- Improved development accessibility
- New wombat crossing to assist pedestrians crossing Stephen Street near the intersection with Morphett Street



Overall Concept



MOUNT BARKER
DISTRICT COUNCIL

Stephen Street
DETAILED DESIGN PLAN

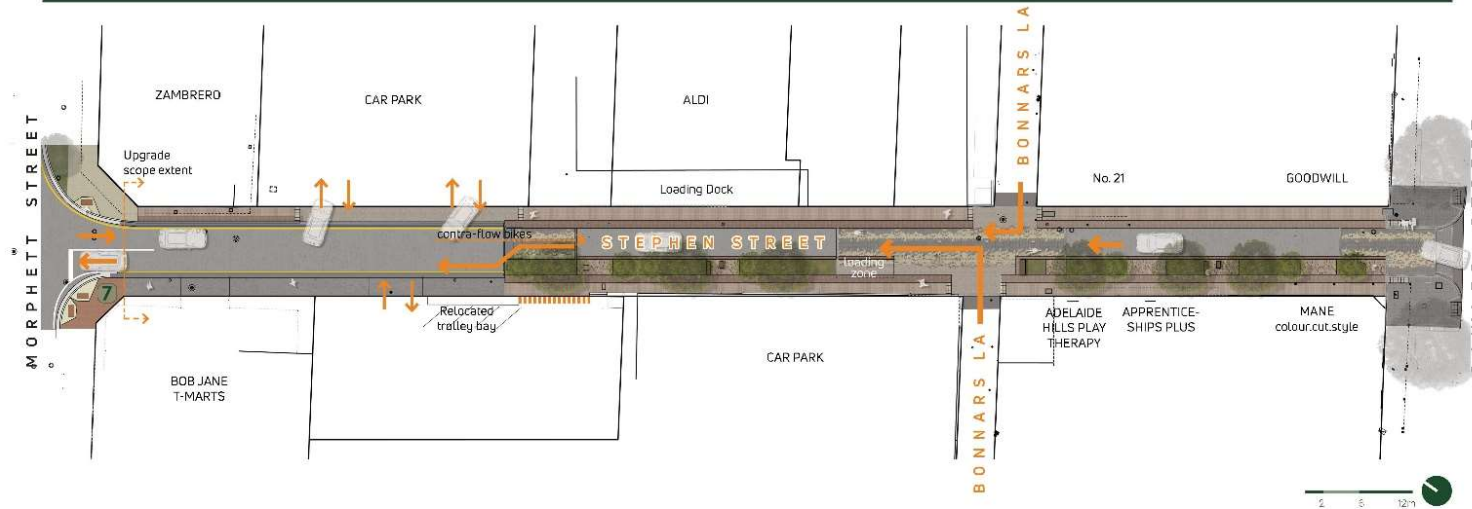

Key Design Features

- 10km/hr Shared Zone (roadway flush with footpaths) from Galwer Street to Aldi loading dock
- Improved crossing over Gawler Street and Bonnars Lane with raised thresholds
- 13 new trees
- New paving and road surfaces
- WSUD planting areas
- New light poles
- New seating areas between the trees

Stephen Street, Mount Barker
Design Development | January 2023 | 4



MOUNT BARKER
DISTRICT COUNCIL

Stephen Street (Morphett St - Aldi Car Park)

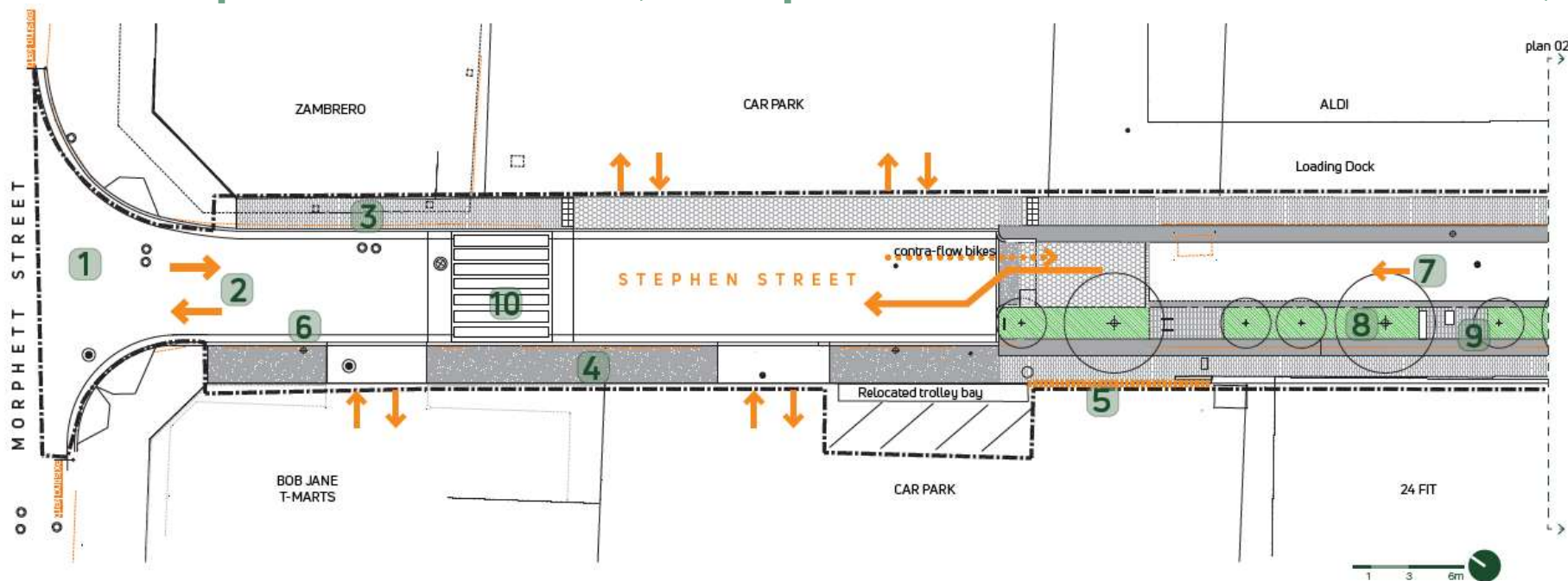

1. MORPHETT STREET INTERSECTION

- Morphett Street footpath and kerb ramps to be retained
- New asphalt to continue to Morphett Street
- Potential for holistic intersection upgrade in the future

2. TWO-WAY VEHICLE MOVEMENT

- Similar width to existing road and footpath to accommodate two-way vehicle movement

3. EASTERN FOOTPATH

- Upgraded brick paving and new charcoal concrete kerb
- Upgraded ALDI car park driveway with interlocking pavers

4. WESTERN FOOTPATH

- Upgraded concrete kerb with asphalt footpaths and driveways

5. REMOVE 2nd ENTRY-EXIT TO CARPARK

- Allows for extension of one-way shared zone, tree planting and garden

6. NEW STREET LIGHTS

- Upgraded street lights for safety
- Relocate light posts to alleviate pinch points in the footpath

7. ONE-WAY SHARED ZONE

- 10km/hr shared zone
- Raised roadway, flush with footpaths - drainage and levels permitting
- contra-flow bikes accepted

8. TREES AND PLANTING

- Deciduous shade trees
- Water sensitive urban design opportunities
- A mixture of tree and plant species for colour, seasonality and 'Hills character'

9. SEATING AREAS

- Seating to provide comfortable stopping points

10. WOMBAT CROSSING

- Facilitating popular existing pedestrian movement
- Improving future pedestrian movement to Town Centre

Stephen Street (Gawler St - Aldi Car Park)

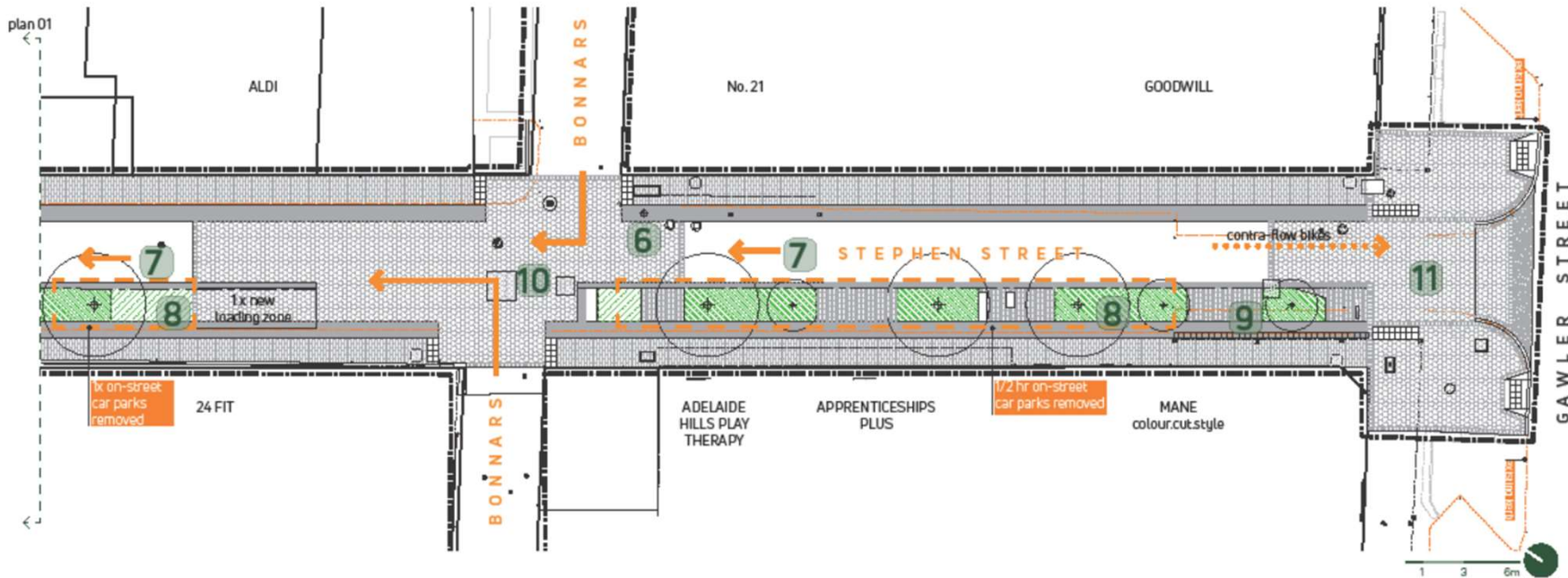

6. NEW STREET LIGHTS

- Upgraded street lights for safety
- Relocate to light posts to alleviate pinch points in the footpath

7. ONE-WAY SHARED ZONE

- 10km/hr shared zone
- Raised roadway, flush with footpaths - drainage and levels permitting

8. TREES AND PLANTING

- Deciduous shade trees
- Water sensitive urban design opportunities
- A mixture of tree and plant species for colour, seasonality and 'Hills character'

9. SEATING AREAS

- Seating and provide comfortable stopping points
- Opportunity for outdoor dining

10. BONNARS LANE INTERSECTION

- Improved pedestrian comfort and accessibility
- Accommodate existing vehicle movements
- Upgraded footpath and road surface materials
- Raised roadway, flush with footpaths

11. GAWLER STREET INTERSECTION

- Raised road threshold for improved pedestrian crossing along Gawler Street
- Upgraded footpath and road surface materials - interlocking pavers for consistency with adjacent Stephen Street plaza



Shared Use Space (Gawler St - Aldi Car Park)



Stephen Street PROJECT SCOPE



The upgrade will be an **exemplar of public realm design**, setting a benchmark for **place making led** public realm projects within the district.

Improving **safety, amenity, tree canopy** and **lighting** will enhance the appeal of the street for walking and cycling both **during the day** and **after-dark**.

This will be key to establishing a strong link between Galwer Street and the new Town Square as well as **encouraging further economic uplift** and **activation of the public realm**.

Innovation

- Water Sensitive Urban Design (WSUD) - rain gardens etc
- Access & Inclusion - 10kph shared use zone
- Street Lighting - LED fittings
- Recycled Materials - promote use in main contract



Community Engagement

- October 2021 - Town Square & Stephen Street Consultation (4 weeks)
- 4 April 2022 - Council Agenda Item - Consultation Summary
 - *broad support for Stephen Street concept design principles*
- October 2022 - Stephen Street (South) Frontager Consultation
 - *support for streetscape upgrade, greening & improved linkage*
 - *some concerns regarding loss of 7 on-street parking spaces*
(ample parking provided for staff/visitors in adjacent car parks)
 - *some traffic speed/safety concerns inc. Morphett Street intersection*
(approval for 10kph shared use zone sought along Stephen Street)
(seeking to include new wombat crossing near Morphett Street intersection)
(Stephen Street/Morphett Street Intersection Upgrade excluded from scope)
- Early February 2023 - Local Accessibility Groups (feedback to come)



Project Budget

Budget

LRCI Funding 22/23 Phase 3 (Streetscape)	- \$ 720,000
Council Pavement Renewal	- \$ 200,000
Council Stormwater Renewal (Stephen St)	- \$ 156,000
Total	- \$ 1,076,000

Cost Estimate

Main Construction Contract	- \$ 850,000
Construction Contingency (10%)	- \$ 85,000
Planning, Design & Investigations	- \$ 95,000
Project Management & Contract Supervision	- \$ 46,000
Total	- \$ 1,076,000



Project Timeline

July 2022	Designer Appointed (Clover Green Space)
October 2022	30% Concept Design
December 2023	70% Preliminary Design
30 January 2023	Council Briefing
Early February 2023	Finalise engagement
Mid-February 2023	100% Detailed Design
March - April 2023	Tender, Evaluation & Contract Award
May 2023 onwards	Construction

